

* PANELS MAY BE PERFORATED (AS SPECIFIED) IN WHICH CASE, ACOUSTICAL BACKER IS RECOMMENDED (1" OR 2" OPTIONS)

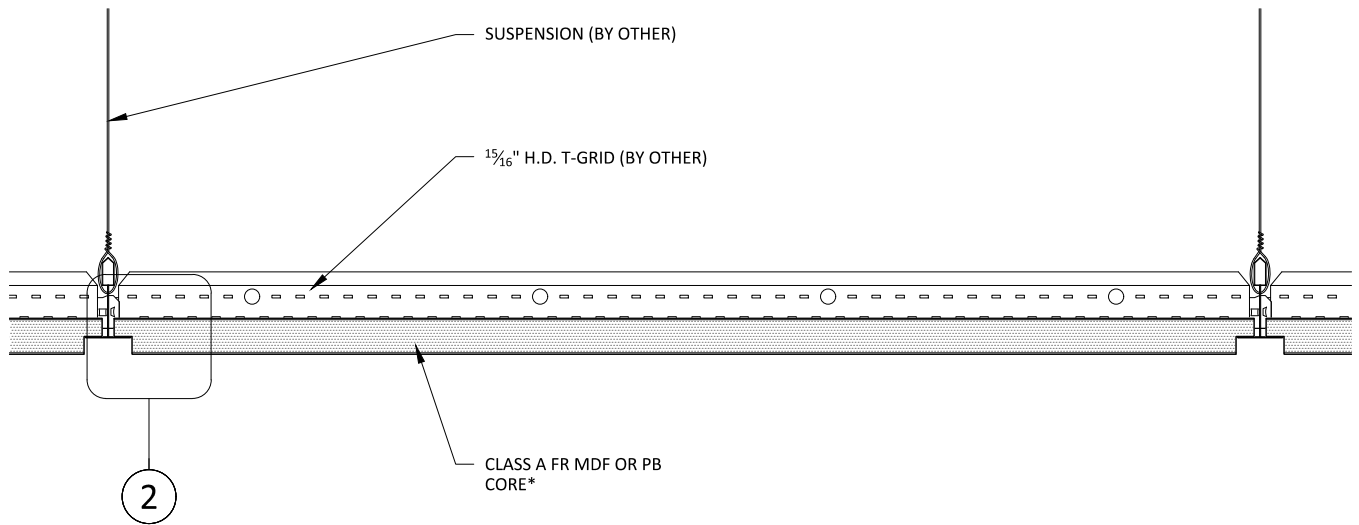

1 TYPICAL SECTION
3" = 1'-0"

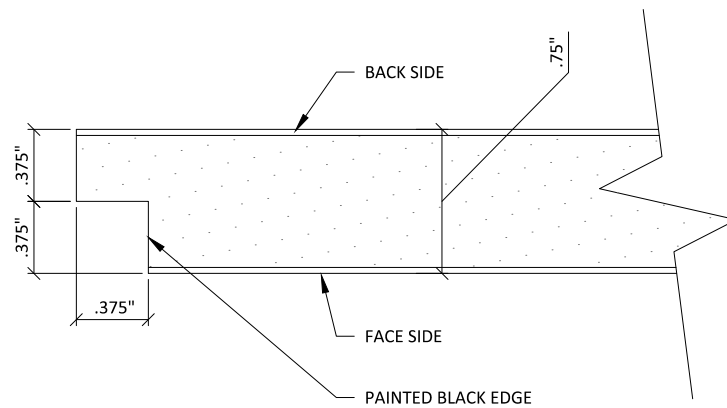

2 RABBET DETAIL
1' = 1'-0"

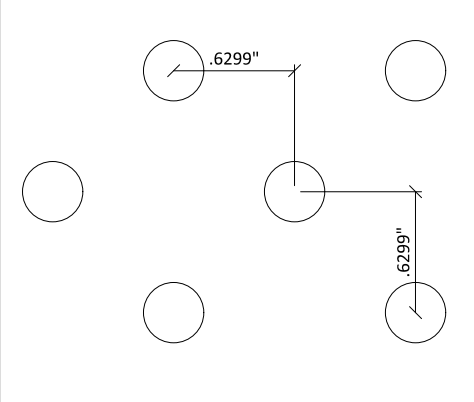
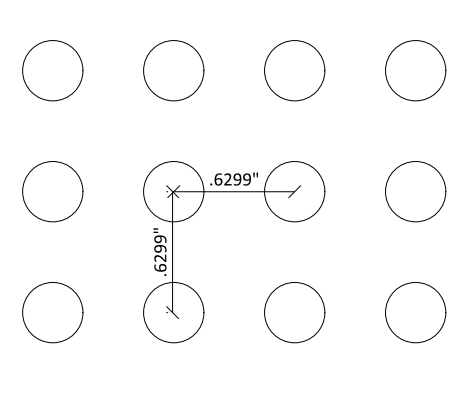
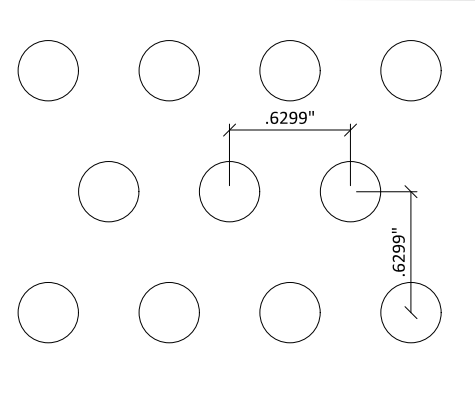
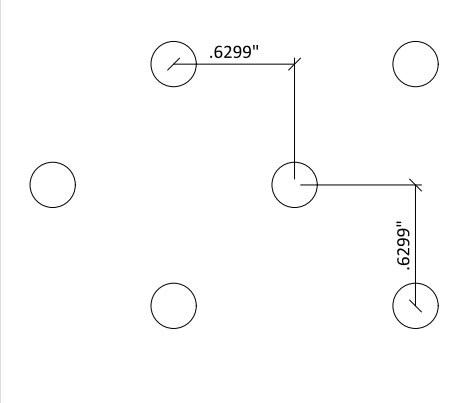
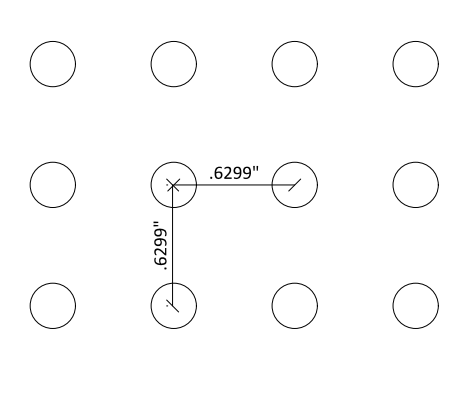
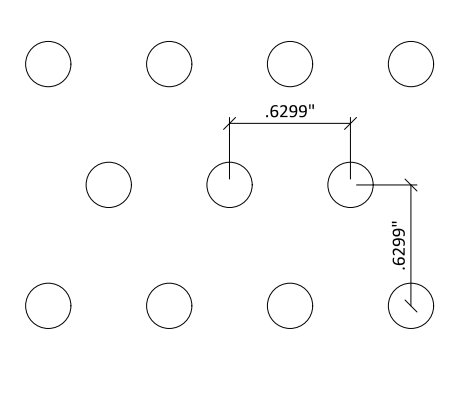
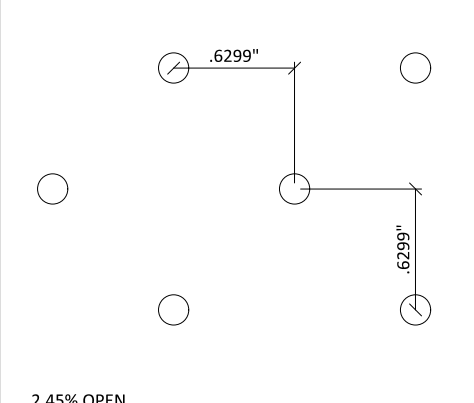
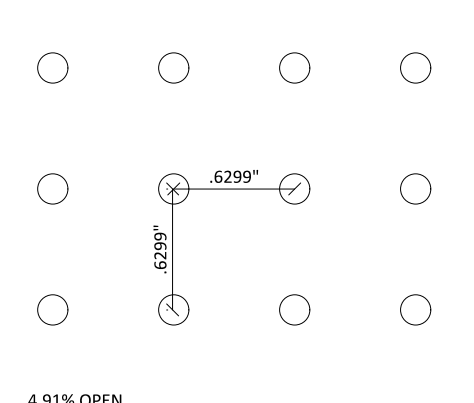
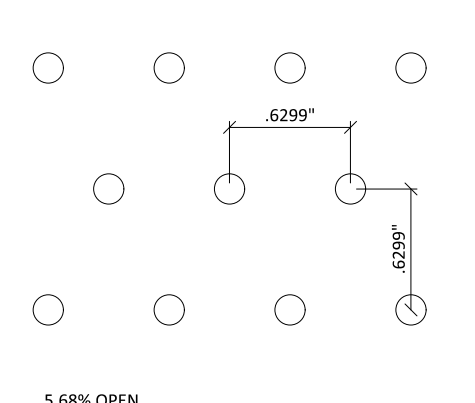
| | | |
|--|--|---|
|  <p>9.81% OPEN</p> |  <p>19.63% OPEN</p> |  <p>22.72% OPEN</p> |
| DIAMOND: 8MM DIA./16MM SPACING | SQUARE: 8MM DIA./16MM SPACING | STAGGERED: 8MM DIA./16MM SPACING |
|  <p>5.52% OPEN</p> |  <p>11.04% OPEN</p> |  <p>12.78% OPEN</p> |
| DIAMOND: 6MM DIA./16MM SPACING | SQUARE: 6MM DIA./16MM SPACING | STAGGERED: 6MM DIA./16MM SPACING |
|  <p>2.45% OPEN</p> |  <p>4.91% OPEN</p> |  <p>5.68% OPEN</p> |
| DIAMOND: 4MM DIA./16MM SPACING | SQUARE: 4MM DIA./16MM SPACING | STAGGERED: 4MM DIA./16MM SPACING |

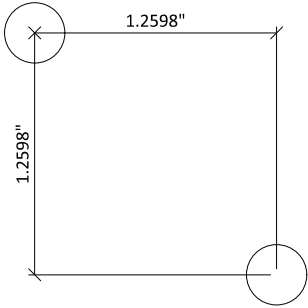
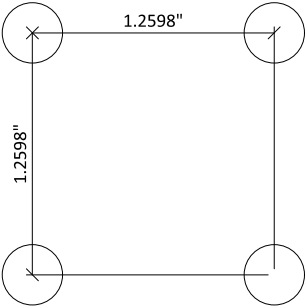
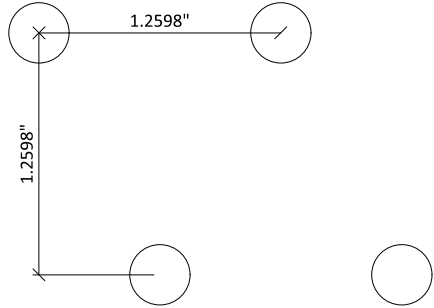
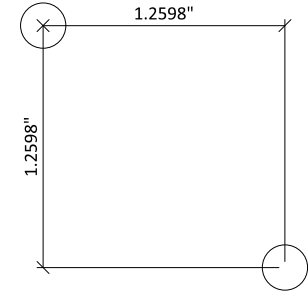
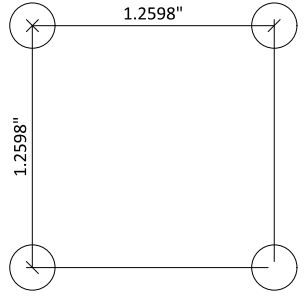
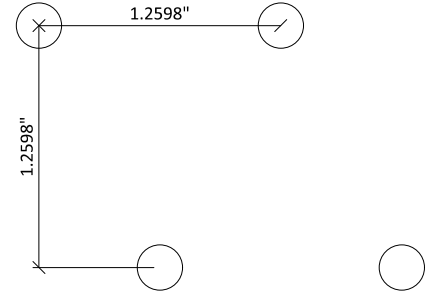
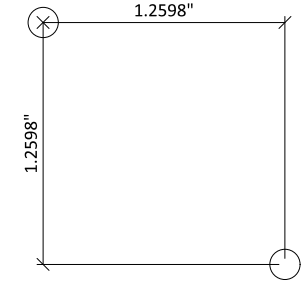
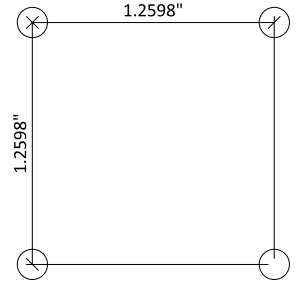
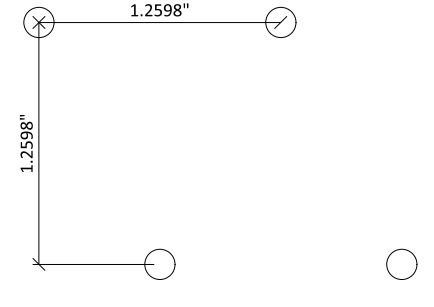
| | | |
|---|---|---|
|  <p>2.45% OPEN</p> |  <p>4.91% OPEN</p> |  <p>5.68% OPEN</p> |
| DIAMOND: 8MM DIA./32MM SPACING | SQUARE: 8MM DIA./32MM SPACING | STAGGERED: 8MM DIA./32MM SPACING |
|  <p>1.38% OPEN</p> |  <p>2.76% OPEN</p> |  <p>3.2% OPEN</p> |
| DIAMOND: 6MM DIA./32MM SPACING | SQUARE: 6MM DIA./32MM SPACING | STAGGERED: 6MM DIA./32MM SPACING |
|  <p>0.61% OPEN</p> |  <p>1.23% OPEN</p> |  <p>1.42% OPEN</p> |
| DIAMOND: 4MM DIA./32MM SPACING | SQUARE: 4MM DIA./32MM SPACING | STAGGERED: 4MM DIA./32MM SPACING |

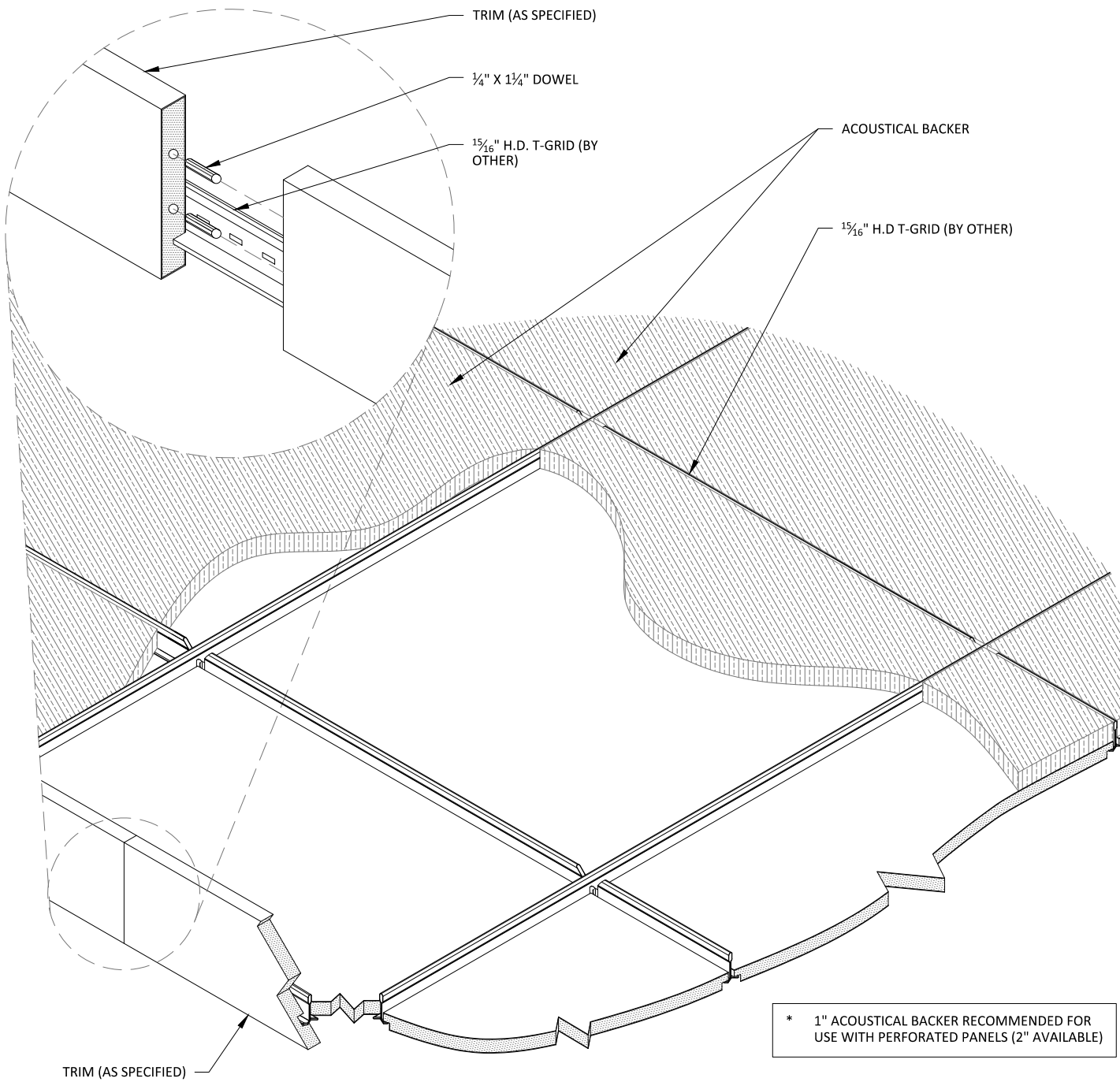

FUSION (RABBETED PANELS) - ISOMETRIC

SCALE: AS NOTED

LAST REVISED: 5/19/2020

DO NOT SCALE DRAWING. FIGURED DIMENSIONS ARE TO BE FOLLOWED. READ THIS DRAWING IN CONNECTION WITH GENERAL ARCHITECTURAL PLANS, STRUCTURAL PLANS, AND OTHER RELATED DRAWINGS. THESE DRAWINGS REPRESENT ASI'S UNDERSTANDING AND INTERPRETATION OF THE ARCHITECTURAL DRAWINGS AND HOW ASI PRODUCTS RELATE TO THE PROJECT. COPYRIGHT ASI © 2020

SHEET NUMBER

4

DRAWN BY: BH

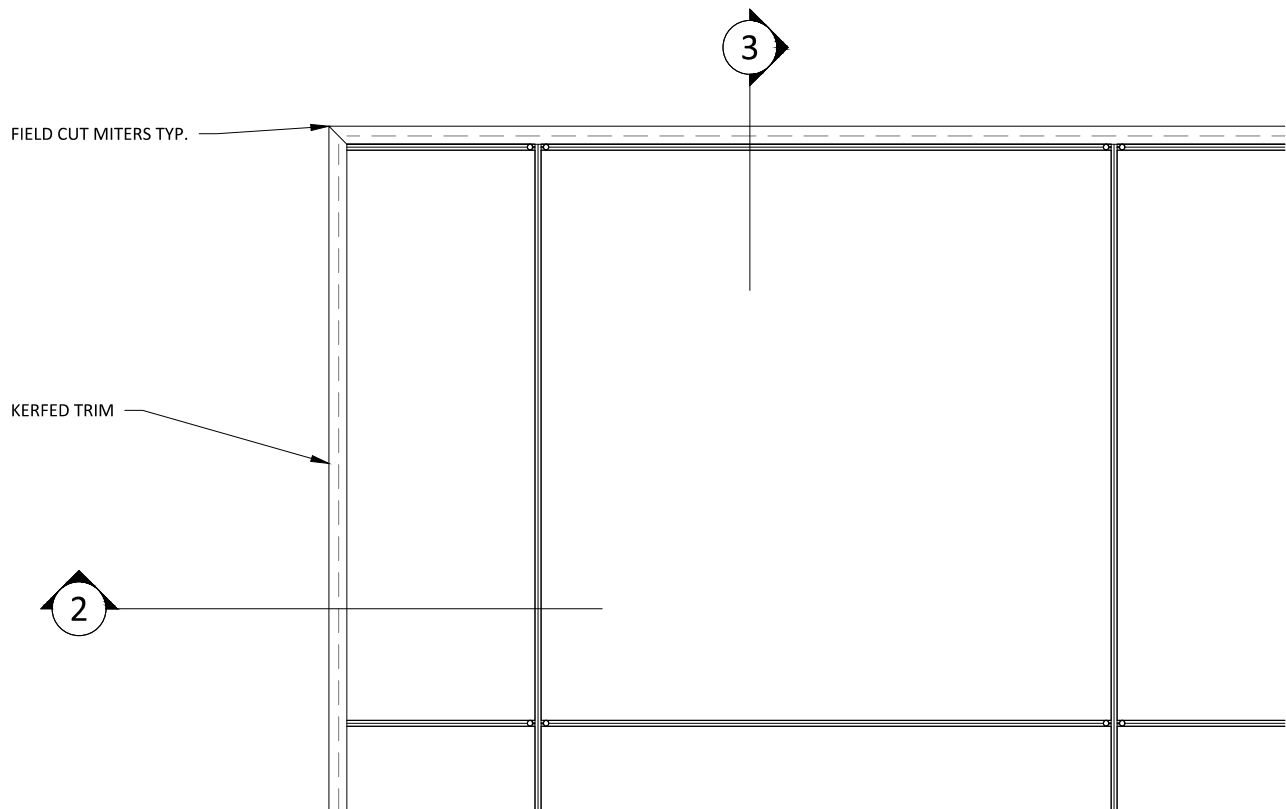

1 TRIM @ MITERED CORNER - PLAN
1 1/2" = 1'-0"

* 1" ACOUSTICAL BACKER RECOMMENDED FOR USE WITH PERFORATED PANELS (2" AVAILABLE)

** ALL FIELD CUTS TO ALLOW FOR 1/2" MIN REVEAL FOR EXPANSION & CONTRACTION

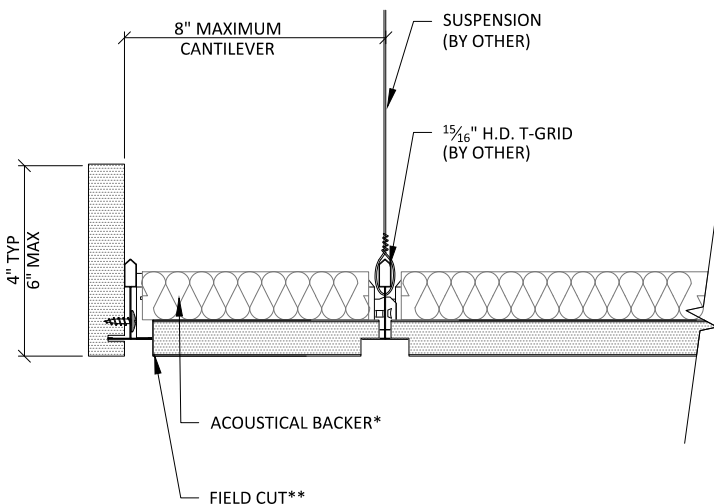

2 TRIM DETAIL 1
3" = 1'-0"

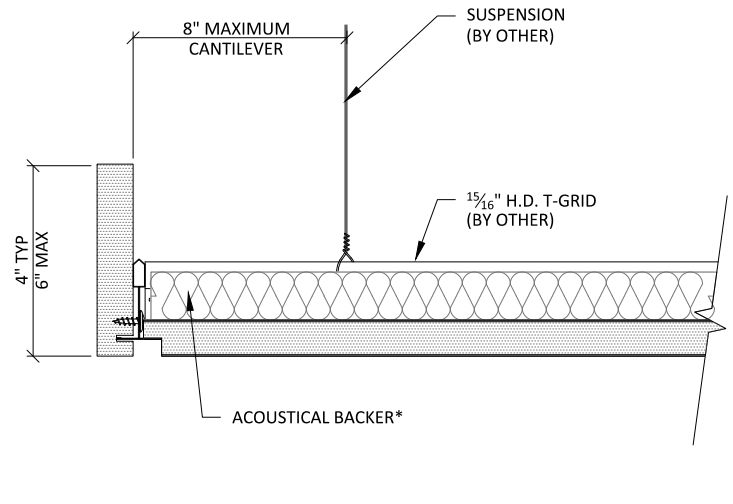

3 TRIM DETAIL 2
3" = 1'-0"

* 1" ACOUSTICAL BACKER RECOMMENDED FOR USE WITH PERFORATED PANELS (2" AVAILABLE)

** ALL FIELD CUTS TO ALLOW FOR $\frac{1}{2}$ " MIN REVEAL FOR EXPANSION & CONTRACTION

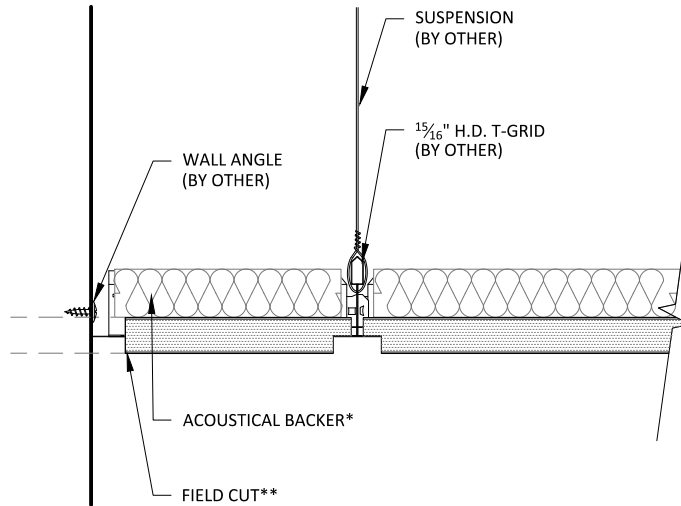

1 EDGE DETAIL 1

3" = 1'-0"

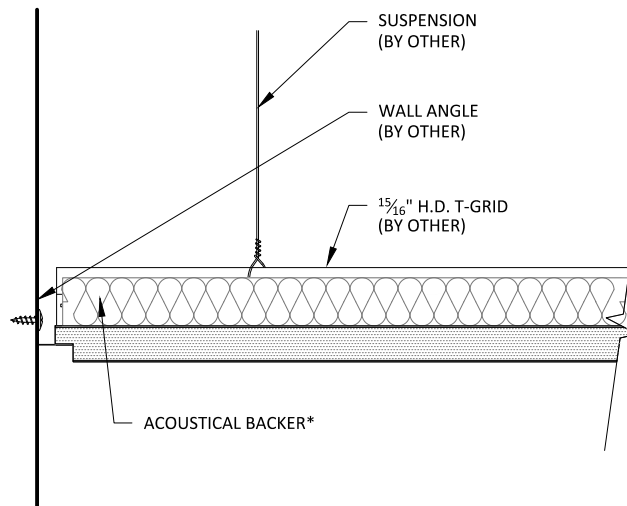

2 EDGE DETAIL 2

3" = 1'-0"

$\frac{15}{16}$ " H.D. T-GRID (BY OTHER)

INDEPENDENTLY SUPPORTED
CUSTOMER FIXTURE (BY OTHER):
FIELD CUT PENETRATION

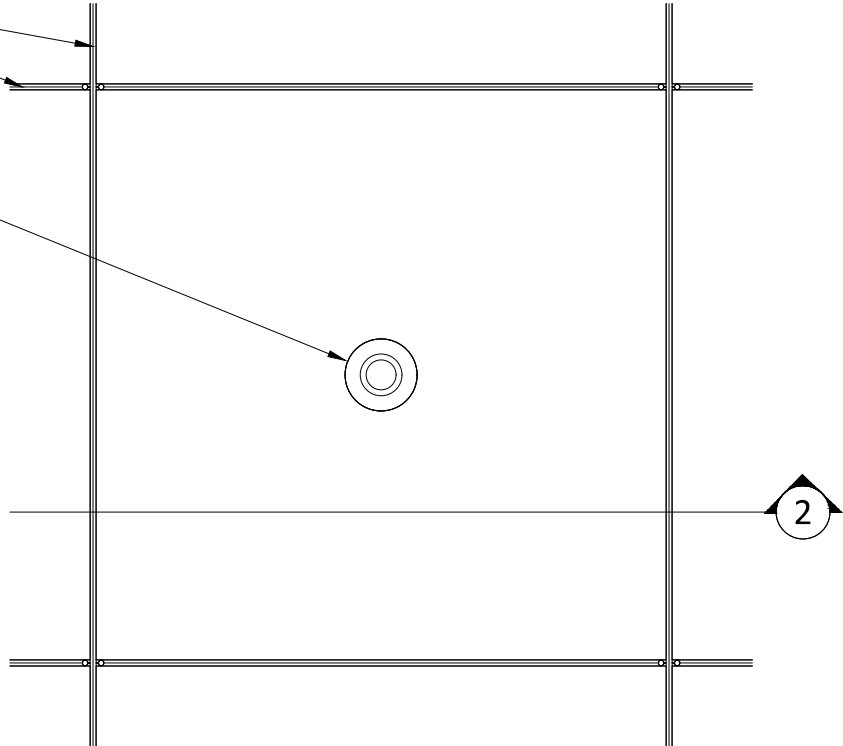

1

SPRINKLER PLAN

1 1/2" = 1'-0"

$\frac{15}{16}$ " H.D. T-GRID (BY OTHER)

INDEPENDENTLY SUPPORTED
CUSTOMER FIXTURE (BY OTHER):
FIELD CUT PENETRATION

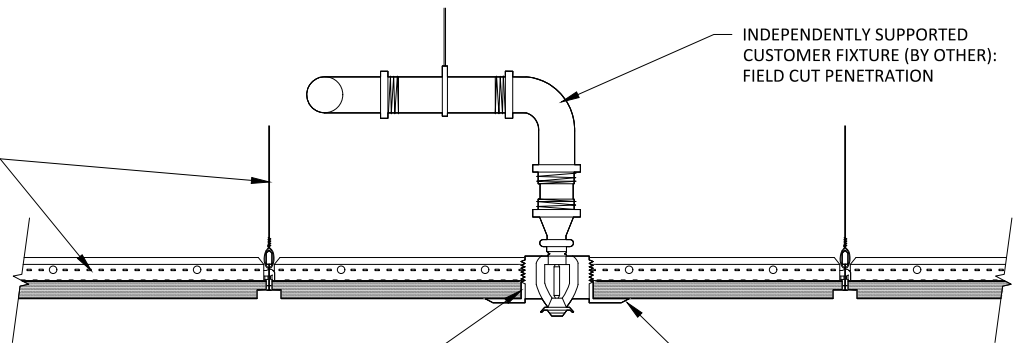

2

SPRINKLER SECTION

1 1/2" = 1'-0"

$\frac{15}{16}$ " H.D. T-GRID (BY OTHER)

INDEPENDENTLY SUPPORTED
CUSTOMER FIXTURE (BY OTHER):
FIELD CUT PENETRATION

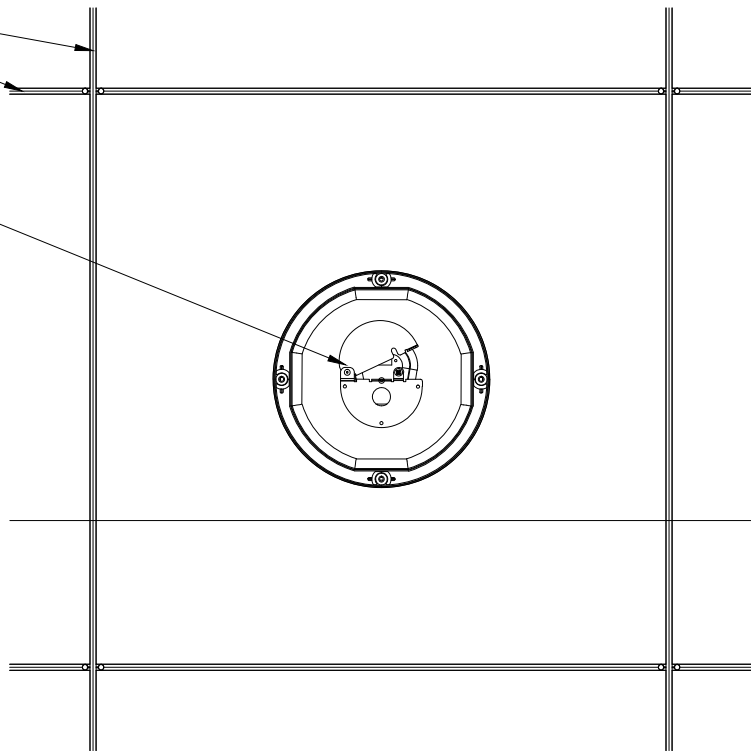

1

CAN LIGHT PLAN

1 1/2" = 1'-0"

$\frac{15}{16}$ " H.D. T-GRID (BY OTHER)

INDEPENDENTLY SUPPORTED
CUSTOMER FIXTURE (BY OTHER):
FIELD CUT PENETRATION

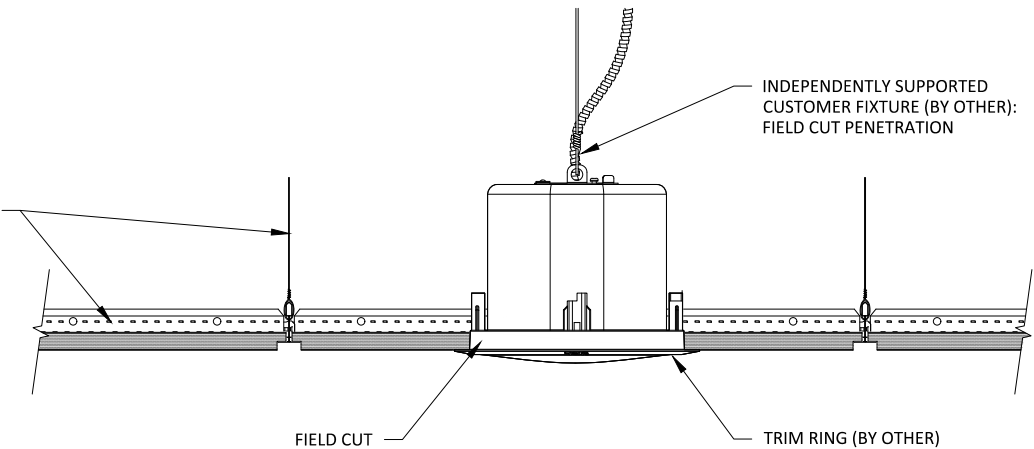

2

CAN LIGHT SECTION

1 1/2" = 1'-0"

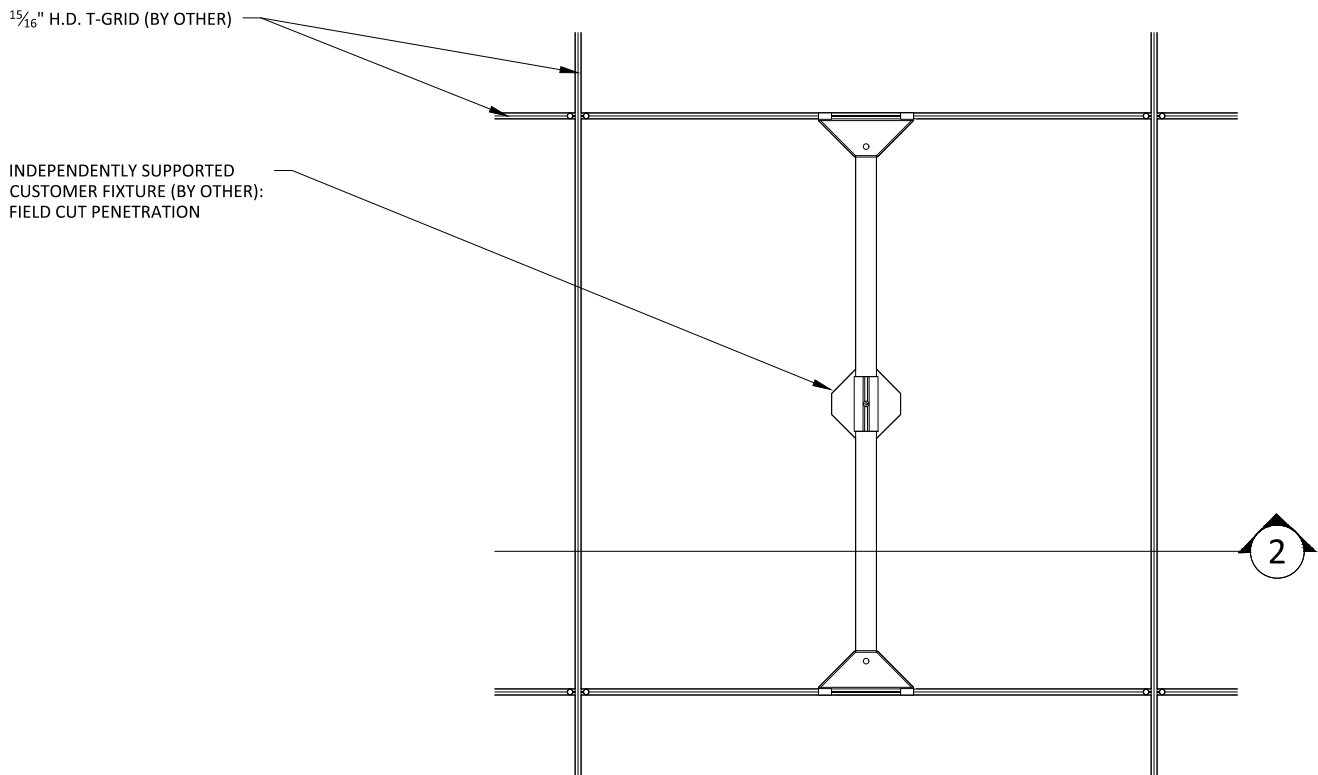

1

PENDANT LIGHT PLAN

1 1/2" = 1'-0"

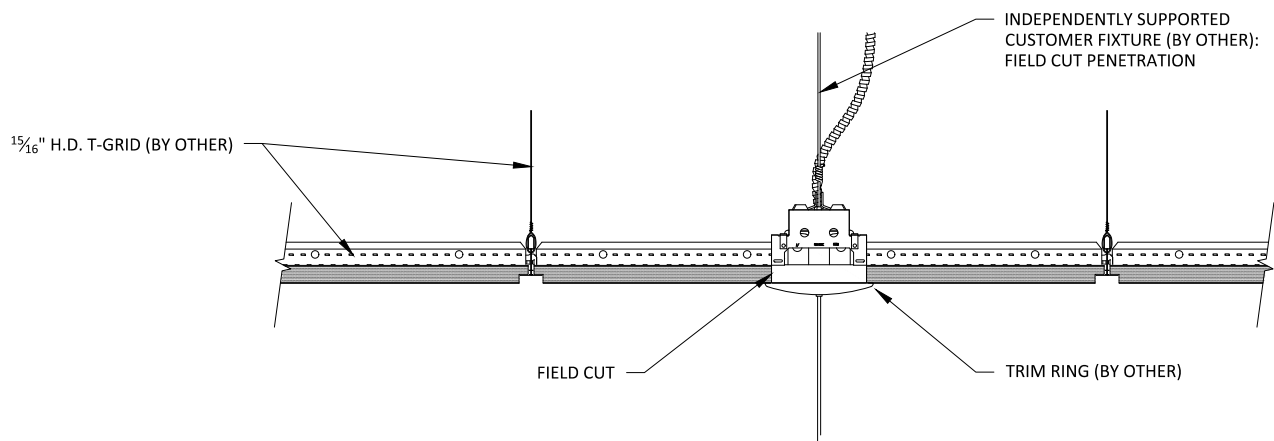

2

PENDANT LIGHT SECTION

1 1/2" = 1'-0"

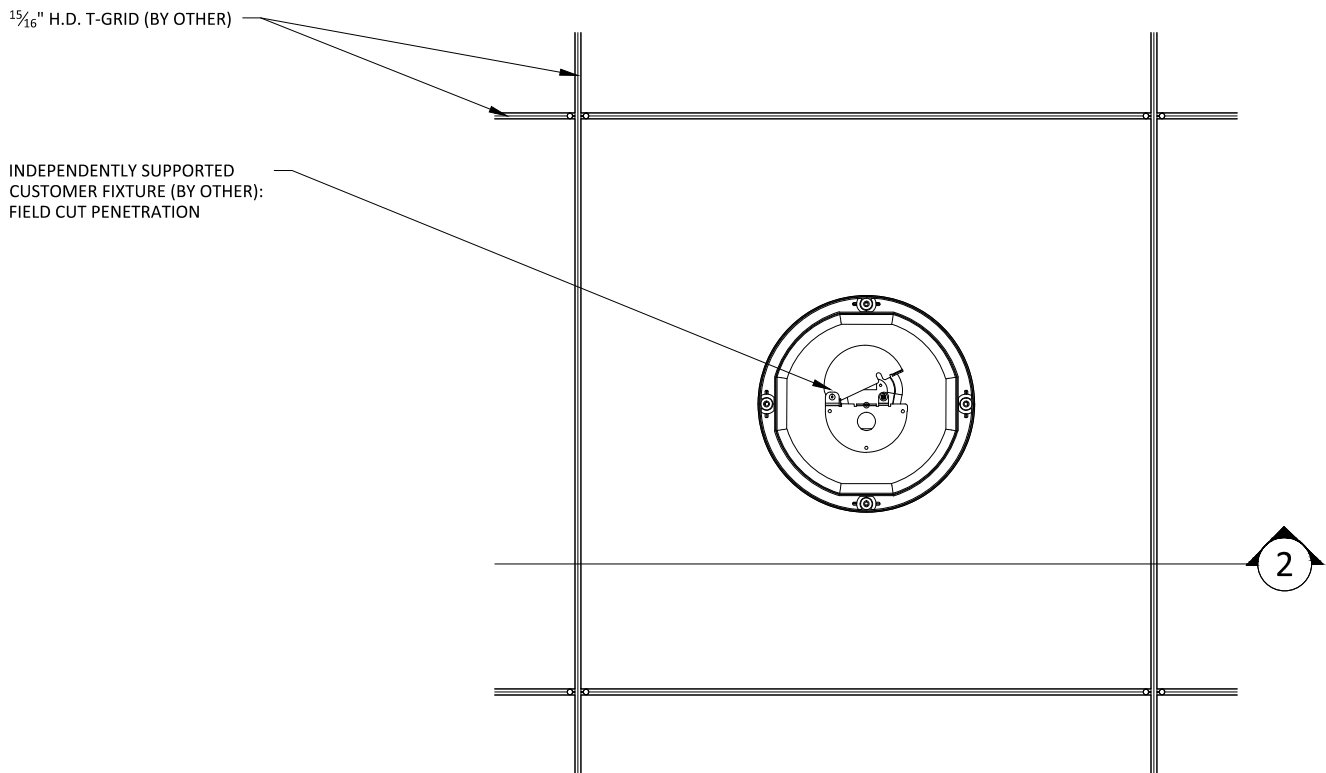

1 RECESSED SPEAKER PLAN
1 1/2" = 1'-0"

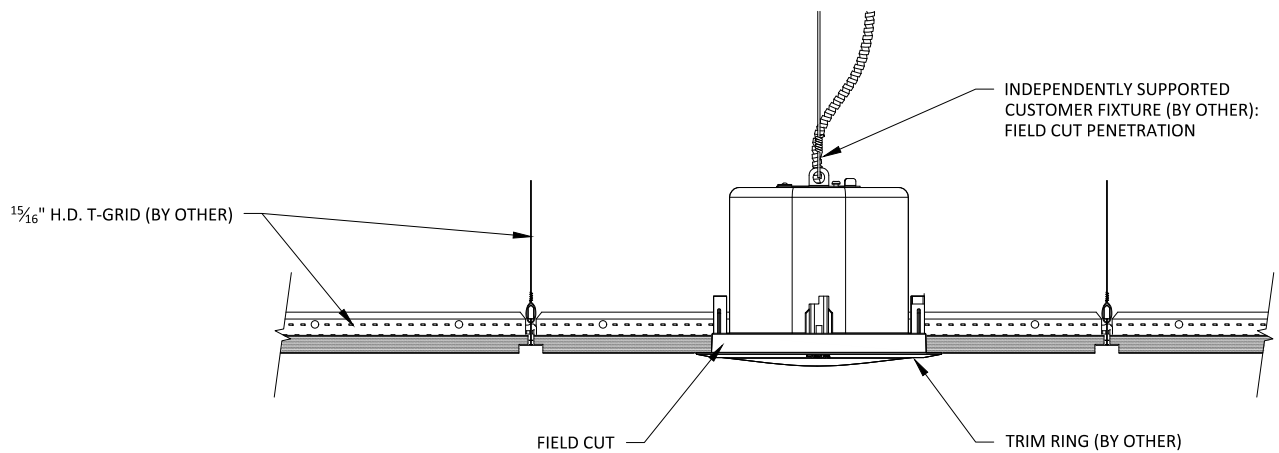

2 RECESSED SPEAKER SECTION
1 1/2" = 1'-0"

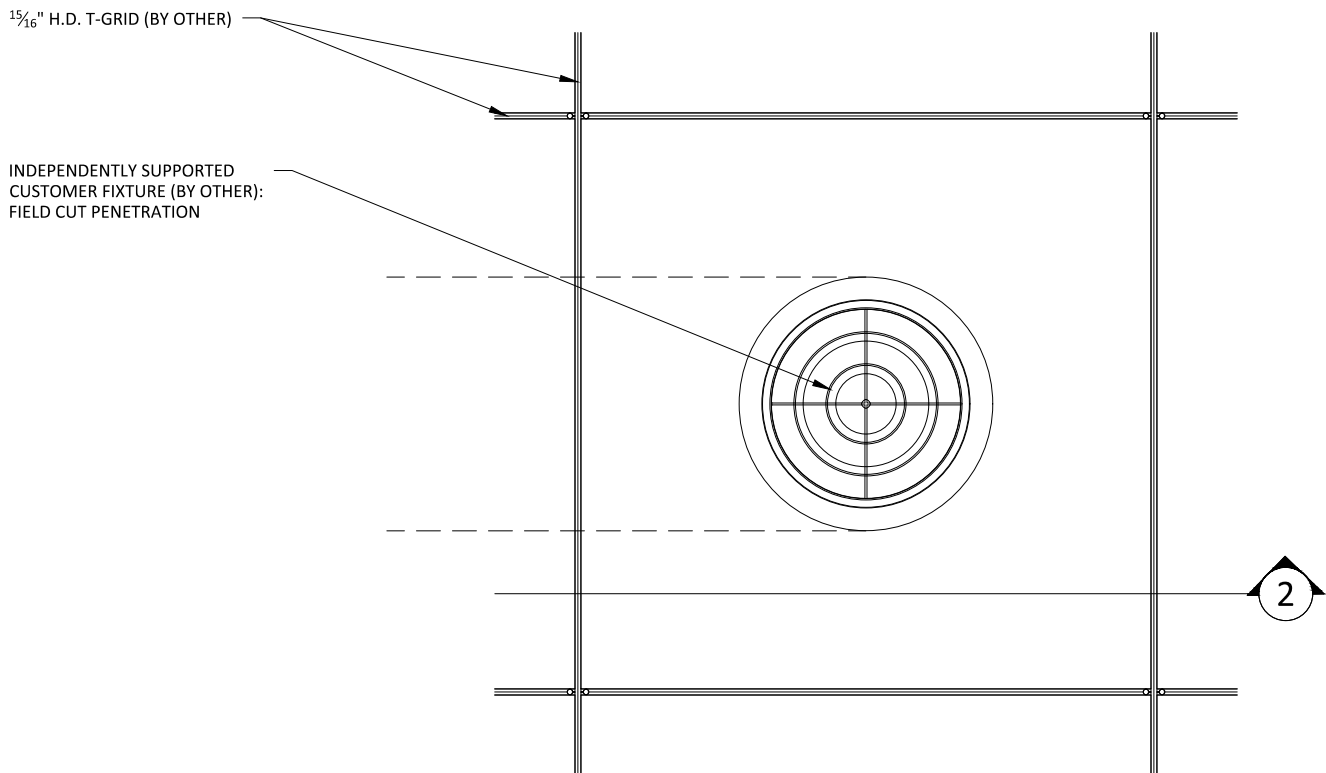

1 DIFFUSER PLAN
1 1/2" = 1'-0"

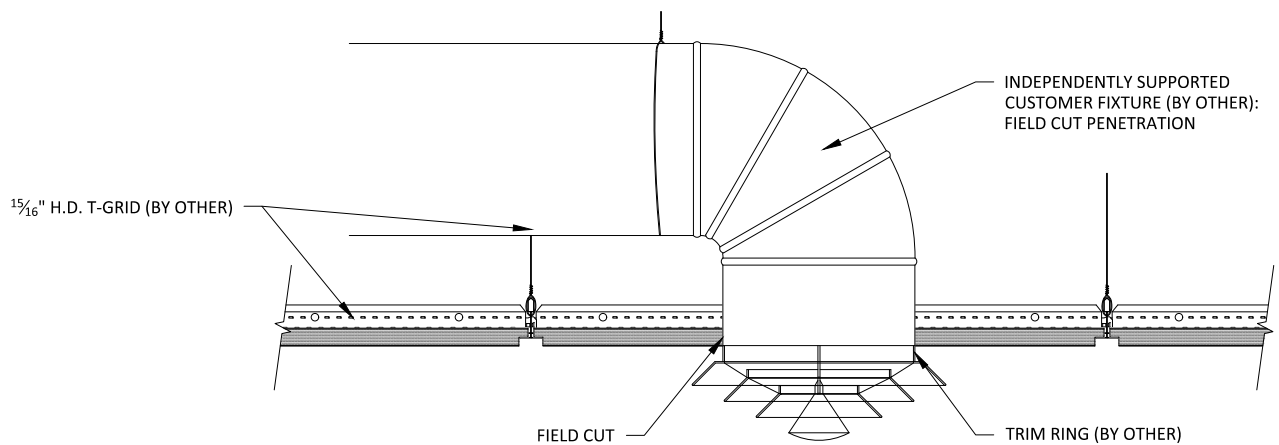

2 DIFFUSER SECTION
1 1/2" = 1'-0"