

1 TYPICAL PANEL OPTIONS
1 SCALE: 3/4" = 1'-0"

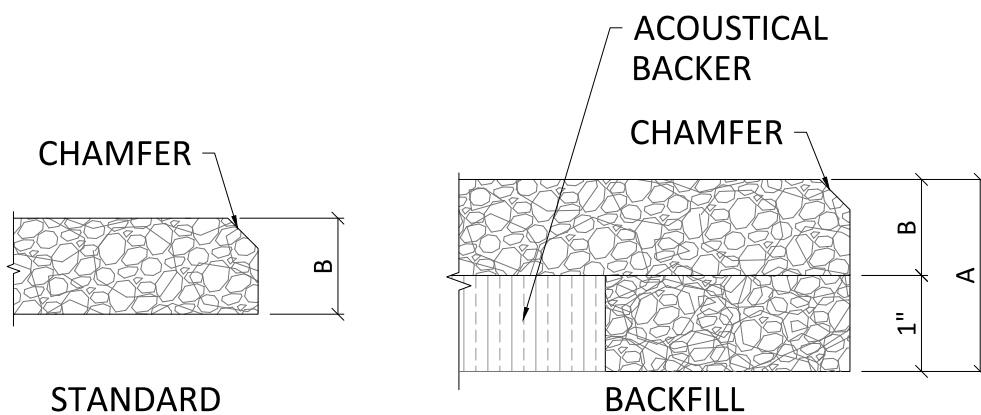

FINISH OPTIONS
PRIMED CLEAR
PRIMED WHITE
CUSTOM PAINTED

PANEL OPTIONS	
A	B
2"	1"
2-3/8"	1-3/8"
3"	2"

2 PANEL PROFILE OPTIONS
1 SCALE: 6" = 1'-0"

STRANDTEC - DIRECT ATTACH CEILING
PANEL OPTIONS

SHEET NUMBER

1

SCALE: AS NOTED

LAST REVISED: 7/5/2022

DRAWN BY: BH

DO NOT SCALE DRAWING. FIGURED DIMENSIONS ARE TO BE FOLLOWED. READ THIS DRAWING IN CONNECTION WITH GENERAL ARCHITECTURAL PLANS, STRUCTURAL PLANS, AND OTHER RELATED DRAWINGS. THESE DRAWINGS REPRESENT ASI'S UNDERSTANDING AND INTERPRETATION OF THE ARCHITECTURAL DRAWINGS AND HOW ASI PRODUCTS RELATE TO THE PROJECT. COPYRIGHT ASI © 2022

SCREW TYPE CHART			
PANEL THICKNESS	SUBSTRATE	RECOMMENDED SCREW TYPE	RECOMMENDED SCREW LENGTH
1"	HAT CHANNEL OR THIN METAL	SELF-TAPPING	2"
1-3/8"	HAT CHANNEL OR THIN METAL	SELF-TAPPING	2-1/4"
2"	HAT CHANNEL OR THIN METAL	SELF-TAPPING	3"
1"	WALL BOARD OR WOOD FURRING	DRYWALL SCREW	1-5/8"
1-3/8"	WALL BOARD OR WOOD FURRING	DRYWALL SCREW	2-1/4"
2"	WALL BOARD OR WOOD FURRING	DRYWALL SCREW	3"
1"	CONCRETE	TAPCON	2-1/4"
1-3/8"	CONCRETE	TAPCON	2-3/4"
2"	CONCRETE	TAPCON	3-1/4"

SCREW SPACING CHART		
APPLICATION	MINIMUM O.C. SPACING	MINIMUM SCREW DISTANCE FROM EDGE OF PANEL
CEILING	12"	$\frac{3}{4}$ "
WALL	24"	$\frac{3}{4}$ "
WALL: HIGH TRAFFIC	12"	$\frac{3}{4}$ "

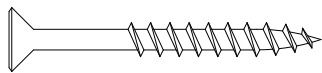

#6 SHARP POINT DRYWALL SCREW RECOMMENDED FOR WOOD APPLICATION



#6 CMU SCREW RECOMMENDED FOR MASONRY APPLICATION

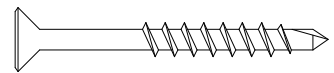

#6 SELF TAPPING SCREW RECOMMENDED FOR METAL APPLICATIONS)



123 Columbia Court North, Chaska,
Minnesota 55318 P. 800.527.6253

STRANDTEC - DIRECT ATTACH CEILING
RECOMMENDED FASTENER OPTIONS

SCALE: AS NOTED

LAST REVISED: 7/5/2022

DRAWN BY: BH

SHEET NUMBER

2

DO NOT SCALE DRAWING. FIGURED DIMENSIONS ARE TO BE FOLLOWED. READ THIS DRAWING IN CONNECTION WITH GENERAL ARCHITECTURAL PLANS, STRUCTURAL PLANS, AND OTHER RELATED DRAWINGS. THESE DRAWINGS REPRESENT ASI'S UNDERSTANDING AND INTERPRETATION OF THE ARCHITECTURAL DRAWINGS AND HOW ASI PRODUCTS RELATE TO THE PROJECT. COPYRIGHT ASI © 2022

SCREW TYPE CHART

PANEL THICKNESS	SUBSTRATE	RECOMMENDED SCREW TYPE	RECOMMENDED SCREW LENGTH
1"	HAT CHANNEL OR THIN METAL	SELF-TAPPING	2"
1-3/8"	HAT CHANNEL OR THIN METAL	SELF-TAPPING	2-1/4"
2"	HAT CHANNEL OR THIN METAL	SELF-TAPPING	3"
1"	WALL BOARD OR WOOD FURRING	WOOD SCREW	1-5/8"
1-3/8"	WALL BOARD OR WOOD FURRING	WOOD SCREW	2-1/4"
2"	WALL BOARD OR WOOD FURRING	WOOD SCREW	3"
1"	CONCRETE	CMU	2-1/4"
1-3/8"	CONCRETE	CMU	2-3/4"
2"	CONCRETE	CMU	3-1/4"

SCREW SPACING CHART

APPLICATION	MINIMUM O.C. SPACING	MINIMUM SCREW DISTANCE FROM EDGE OF PANEL
CEILING	12"	$\frac{3}{4}$ "
WALL	24"	$\frac{3}{4}$ "
WALL: HIGH TRAFFIC	12"	$\frac{3}{4}$ "

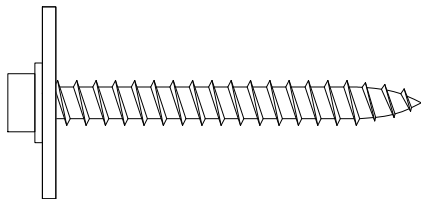

$\frac{1}{4}$ "-14 HEX WOOD
SCREW W/ 1" WASHER

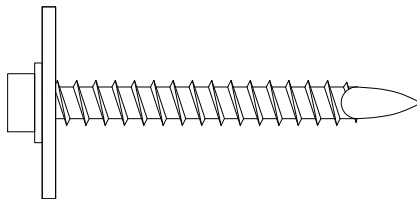

$\frac{1}{4}$ "-14 HEX CMU
SCREW W/ 1" WASHER

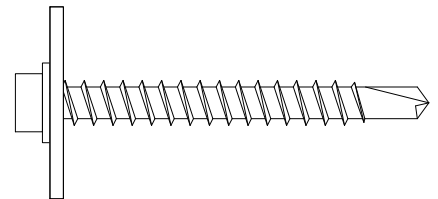

$\frac{1}{4}$ "-14 HEX METAL
SCREW W/ 1" WASHER



123 Columbia Court North, Chaska,
Minnesota 55318 P. 800.527.6253

STRANDTEC - DIRECT ATTACH CEILING
ALTERNATE RECOMMENDED FASTENER OPTIONS

SCALE: AS NOTED

LAST REVISED: 7/5/2022

DRAWN BY: BH

SHEET NUMBER

3

DO NOT SCALE DRAWING. FIGURED DIMENSIONS ARE TO BE FOLLOWED. READ THIS DRAWING IN CONNECTION WITH GENERAL ARCHITECTURAL PLANS, STRUCTURAL PLANS, AND OTHER RELATED DRAWINGS. THESE DRAWINGS REPRESENT ASI'S UNDERSTANDING AND INTERPRETATION OF THE ARCHITECTURAL DRAWINGS AND HOW ASI PRODUCTS RELATE TO THE PROJECT. COPYRIGHT ASI © 2022

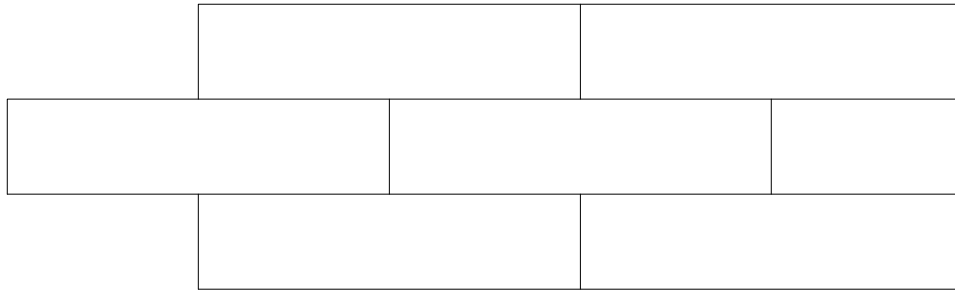

TYPICAL 2X8 PANEL LAYOUT

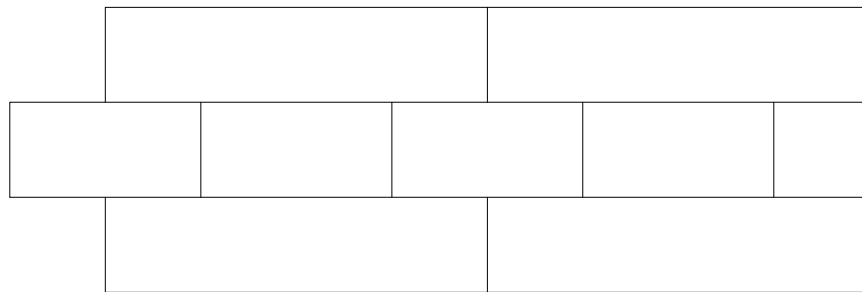

2X8 / 2X4 PANEL LAYOUT

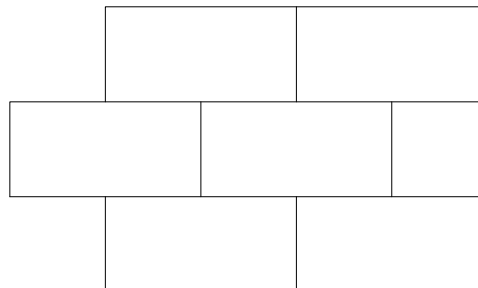

TYPICAL 2X4 PANEL LAYOUT

- ALL ENDS MUST BE STAGGERED (AS SHOWN)
- ALL ENDS MUST FALL ON FURRING OR DRYWALL T-GRID
- 2X8 PANELS AND 2X4 PANELS CAN BE USED INTERCHANGEABLY
(ONE 2X4 PANEL IS EXACTLY HALF THE LENGTH OF ONE 2X8 PANEL)

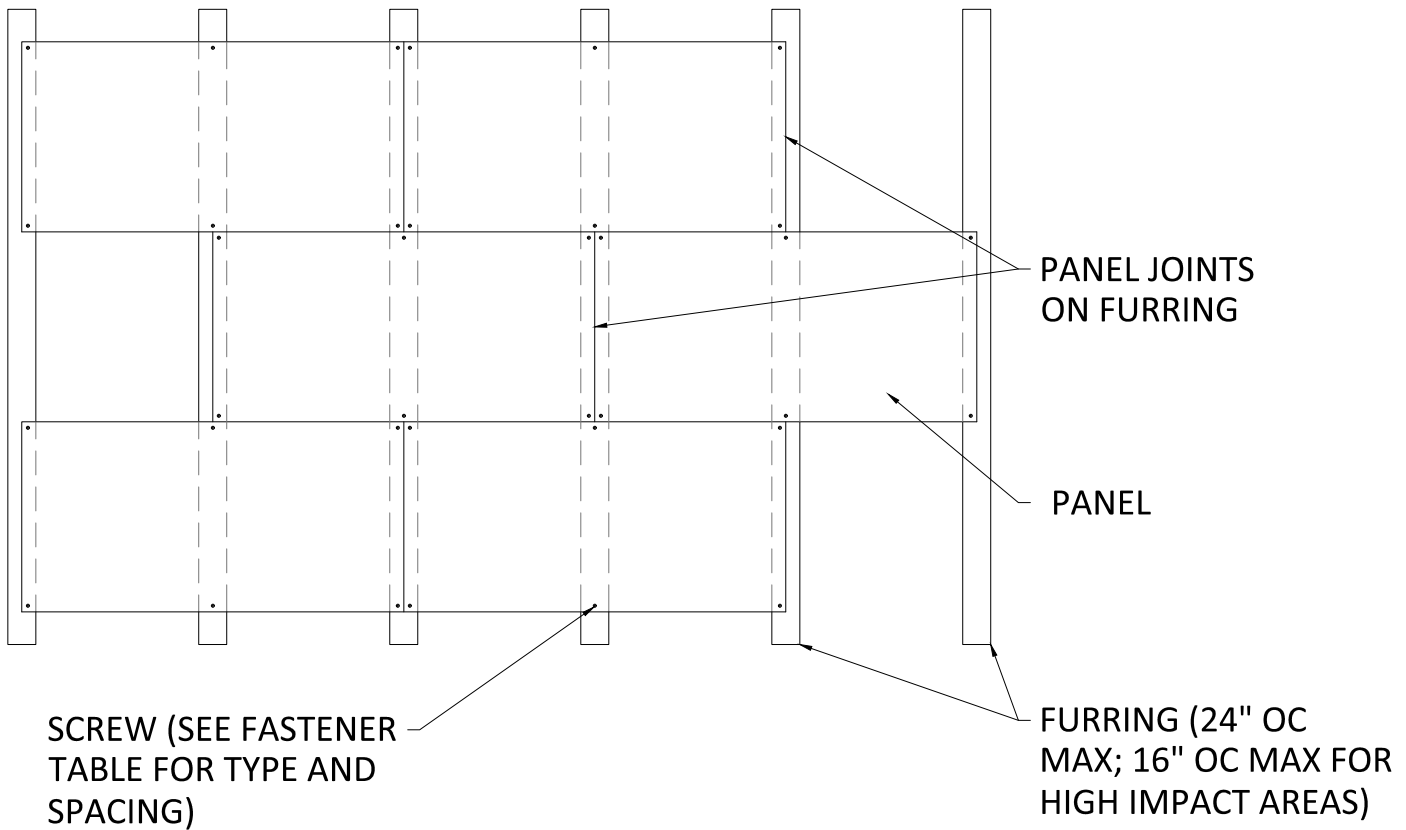

- FURRING TO BE PERPENDICULAR TO LENGTH OF PANEL
- ENDS TO BE STAGGERED AND FALL ON FURRING
- PANELS TO BE SCREWED TO FURRING (SEE FASTENER TABLE FOR TYPE AND SPACING)
- CONFIGURATION APPLIES TO ALL SIZES (2X4 PANEL SHOWN)

	PANEL SIZE	
NOMINAL	2X4	2X8
ACTUAL SIZE	24" X 48"	24" X 96"
RECOMMENDED FURRING SPACING	24" O.C.	24" O.C.

H.D. DRYWALL T-GRID
MAIN (4' O.C. MAX.)

H.D. DRYWALL T-GRID
CROSS TEE (SEE SHEET
5 FOR SPACING)

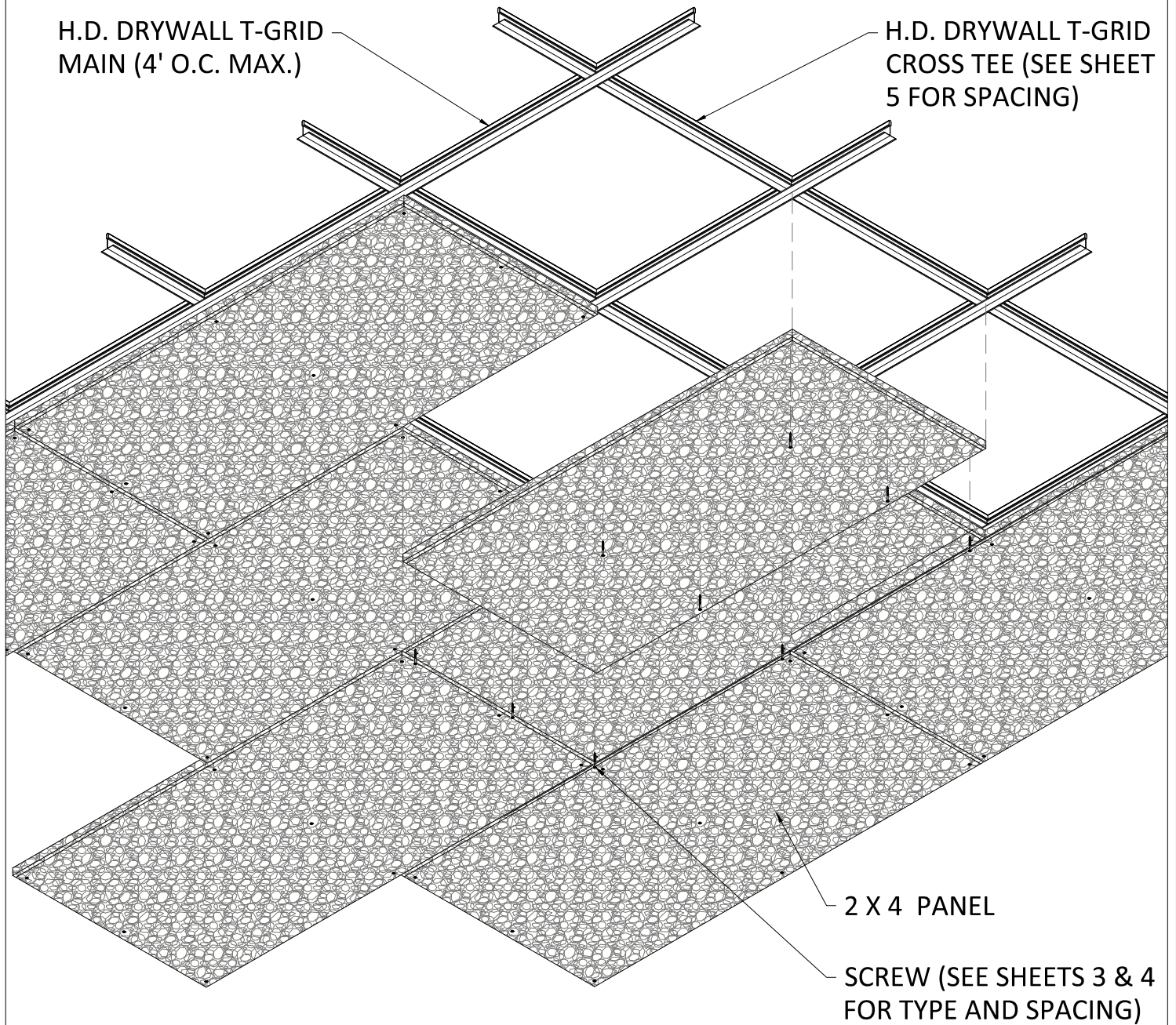

1 DIRECT ATTACH ISOMETRIC (2X4 PANEL)
6 SCALE: 3/4" = 1'-0"

DRYWALL T-GRID
MAINS (BY OTHER)

INDEPENDENTLY SUPPORTED
CUSTOMER FIXTURE (FIELD
CUT PENETRATION)

SCREW (SEE FASTENER
TABLE FOR TYPE AND
SPACING)

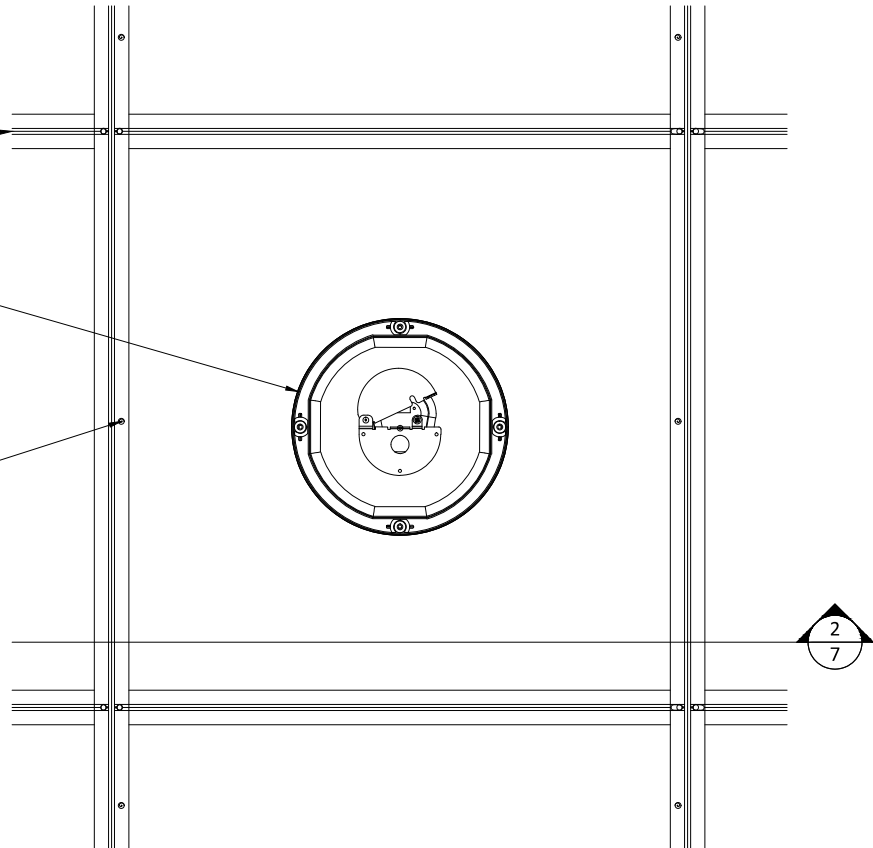

1 DIRECT ATTACH CAN LIGHT PLAN
SCALE: 1 1/2" = 1'-0"

SUSPENSION (BY OTHER)

DRYWALL T-GRID
(BY OTHER)

SCREW (SEE FASTENER TABLE
FOR TYPE AND SPACING)

FIELD CUT
PENETRATION

INDEPENDENTLY
SUPPORTED CUSTOMER
FIXTURE (BY OTHER)

TRIM RING (BY OTHER)

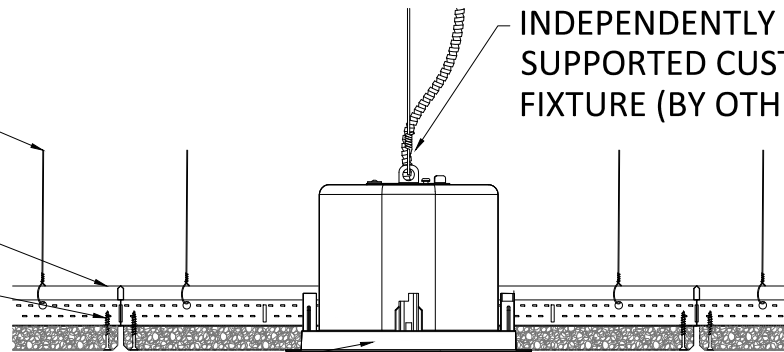

2 DIRECT ATTACH CAN LIGHT SECTION
SCALE: 1 1/2" = 1'-0"

DRYWALL T-GRID
MAINS (BY OTHER)

INDEPENDENTLY SUPPORTED
CUSTOMER FIXTURE (FIELD
CUT PENETRATION)

SCREW (SEE FASTENER
TABLE FOR TYPE AND
SPACING)

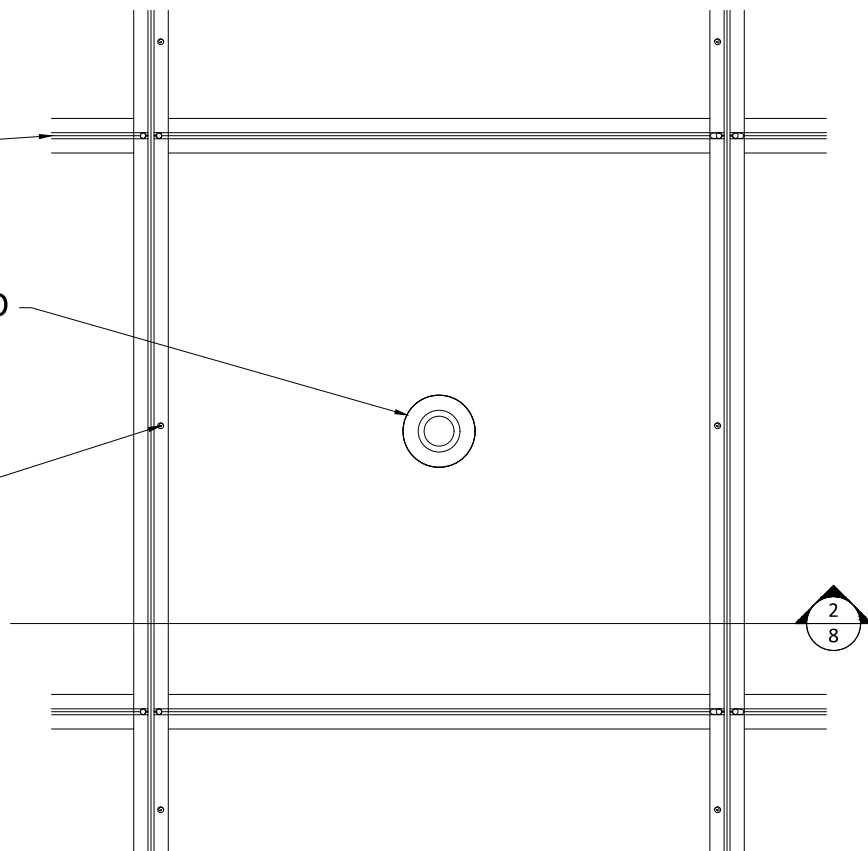

1 DIRECT ATTACH SPRINKLER PLAN
SCALE: 1 1/2" = 1'-0"

SUSPENSION (BY OTHER)

DRYWALL T-GRID
(BY OTHER)

SCREW (SEE FASTENER TABLE
FOR TYPE AND SPACING)

FIELD CUT
PENETRATION

INDEPENDENTLY
SUPPORTED CUSTOMER
FIXTURE (BY OTHER)

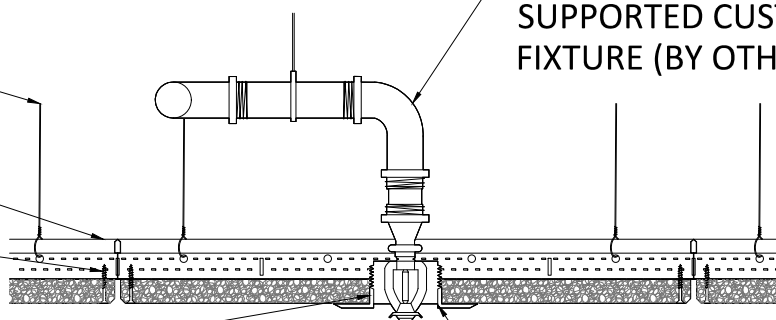

TRIM RING (BY OTHER)

2 DIRECT ATTACH SPRINKLER SECTION
SCALE: 1 1/2" = 1'-0"

STRANDTEC - DIRECT ATTACH CEILING SPRINKLER DETAILS

SCALE: AS NOTED

LAST REVISED: 7/5/2022

DRAWN BY: BH

SHEET NUMBER

8



123 Columbia Court North, Chaska,
Minnesota 55318 P. 800.527.6253

DO NOT SCALE DRAWING. FIGURED DIMENSIONS ARE TO BE FOLLOWED. READ THIS DRAWING IN CONNECTION WITH GENERAL ARCHITECTURAL PLANS, STRUCTURAL PLANS, AND OTHER RELATED DRAWINGS. THESE DRAWINGS REPRESENT ASI'S UNDERSTANDING AND INTERPRETATION OF THE ARCHITECTURAL DRAWINGS AND HOW ASI PRODUCTS RELATE TO THE PROJECT. COPYRIGHT ASI © 2022

DRYWALL T-GRID
MAINS (BY OTHER)

INDEPENDENTLY SUPPORTED
CUSTOMER FIXTURE (FIELD
CUT PENETRATION)

SCREW (SEE FASTENER
TABLE FOR TYPE AND
SPACING)

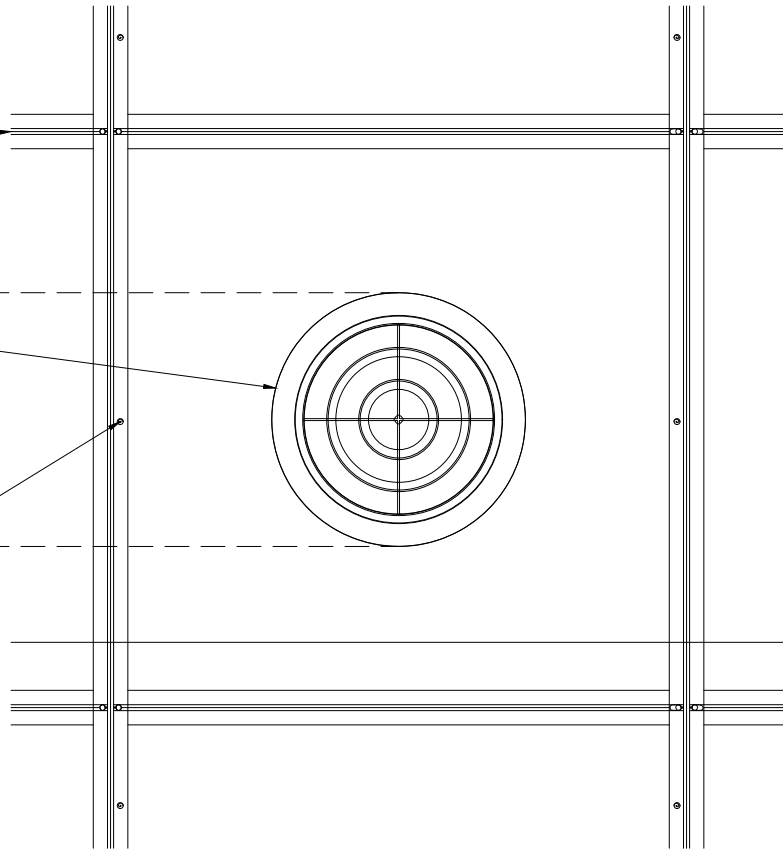

1 DIRECT ATTACH DIFFUSER PLAN
SCALE: 1 1/2" = 1'-0"

SUSPENSION (BY OTHER)

INDEPENDENTLY
SUPPORTED CUSTOMER
FIXTURE (BY OTHER)

DRYWALL T-GRID
(BY OTHER)

SCREW (SEE FASTENER TABLE
FOR TYPE AND SPACING)

FIELD CUT
PENETRATION

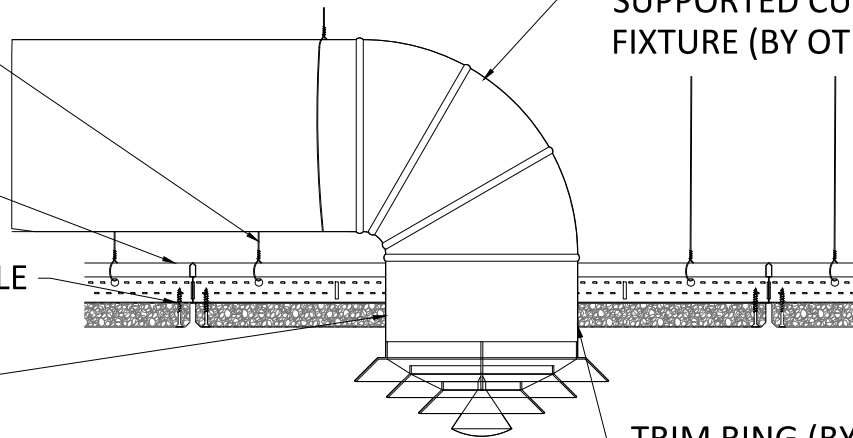

TRIM RING (BY OTHER)

2 DIRECT ATTACH DIFFUSER SECTION
SCALE: 1 1/2" = 1'-0"



123 Columbia Court North, Chaska,
Minnesota 55318 P. 800.527.6253

STRANDTEC - DIRECT ATTACH CEILING DIFFUSER DETAILS

SCALE: AS NOTED

LAST REVISED: 7/5/2022

DRAWN BY: BH

SHEET NUMBER

9

DO NOT SCALE DRAWING. FIGURED DIMENSIONS ARE TO BE FOLLOWED. READ THIS DRAWING IN CONNECTION WITH GENERAL ARCHITECTURAL PLANS, STRUCTURAL PLANS, AND OTHER RELATED DRAWINGS. THESE DRAWINGS REPRESENT ASI'S UNDERSTANDING AND INTERPRETATION OF THE ARCHITECTURAL DRAWINGS AND HOW ASI PRODUCTS RELATE TO THE PROJECT. COPYRIGHT ASI © 2022

DRYWALL T-GRID
MAINS (BY OTHER)

INDEPENDENTLY SUPPORTED
CUSTOMER FIXTURE (FIELD
CUT PENETRATION)

SCREW (SEE FASTENER
TABLE FOR TYPE AND
SPACING)

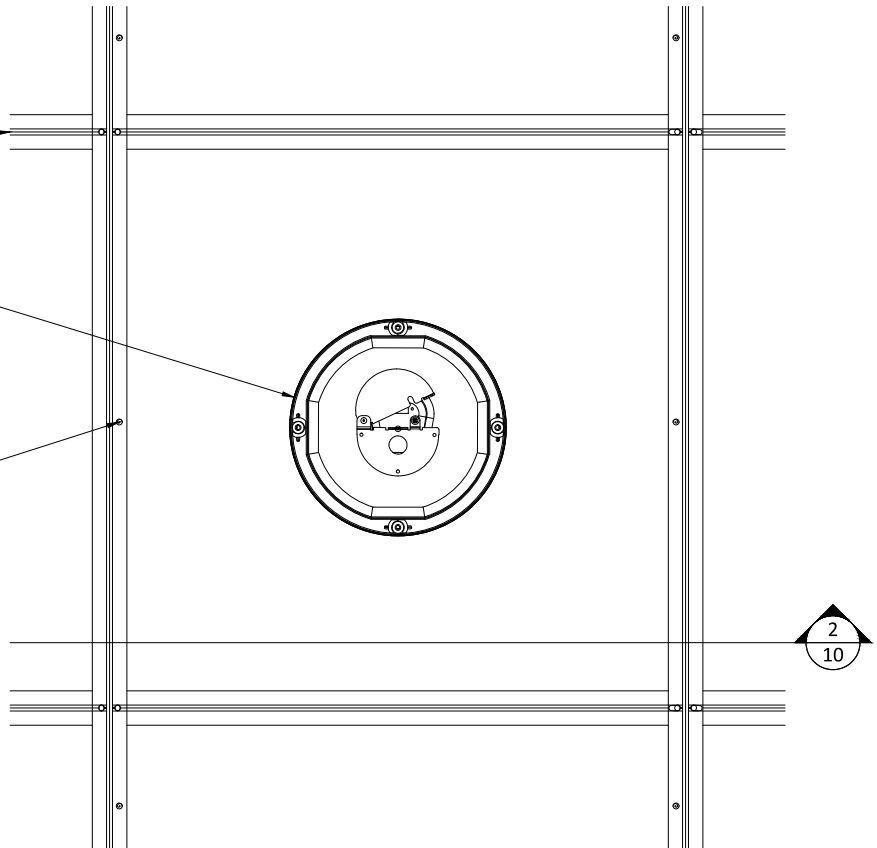

1 DIRECT ATTACH SPEAKER PLAN
10 SCALE: 1 1/2" = 1'-0"

SUSPENSION (BY OTHER)

DRYWALL T-GRID
(BY OTHER)

SCREW (SEE FASTENER TABLE
FOR TYPE AND SPACING)

FIELD CUT
PENETRATION

INDEPENDENTLY
SUPPORTED CUSTOMER
FIXTURE (BY OTHER)

TRIM RING (BY OTHER)

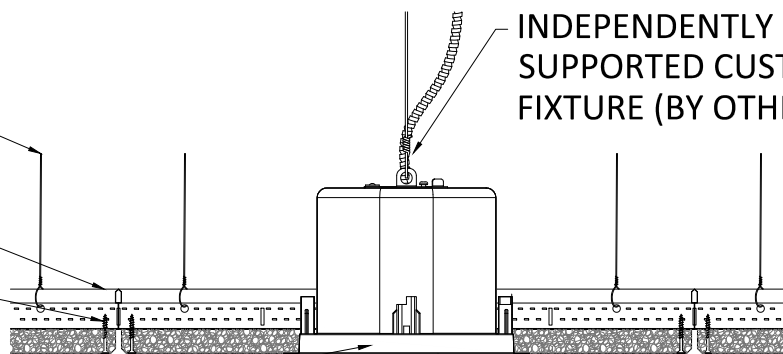

2 DIRECT ATTACH SPEAKER SECTION
10 SCALE: 1 1/2" = 1'-0"

DRYWALL T-GRID
MAINS (BY OTHER)

INDEPENDENTLY SUPPORTED
CUSTOMER FIXTURE (FIELD
CUT PENETRATION)

SCREW (SEE FASTENER
TABLE FOR TYPE AND
SPACING)

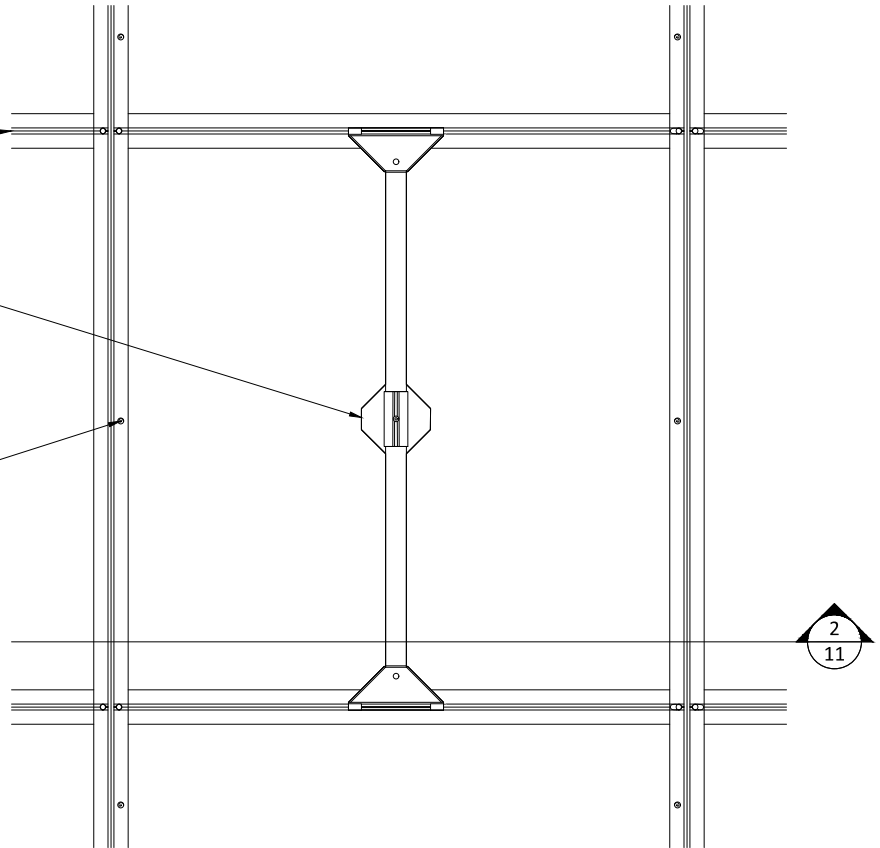

1
11 DIRECT ATTACH PENDANT LIGHT PLAN
SCALE: 1 1/2" = 1'-0"

SUSPENSION (BY OTHER)

DRYWALL T-GRID
(BY OTHER)

SCREW (SEE FASTENER TABLE
FOR TYPE AND SPACING)

FIELD CUT
PENETRATION

INDEPENDENTLY
SUPPORTED CUSTOMER
FIXTURE (BY OTHER)

TRIM RING (BY OTHER)

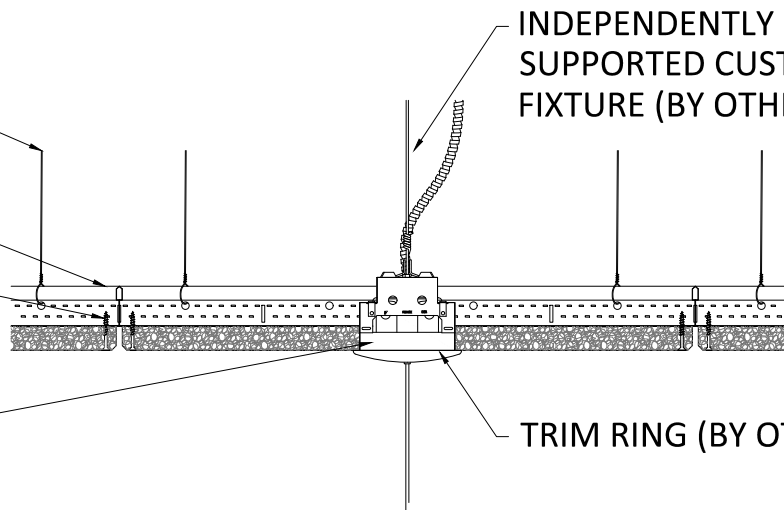

2
11 DIRECT ATTACH PENDANT LIGHT SECTION
SCALE: 1 1/2" = 1'-0"